

Home Care

Liquid Oxygen Respiratory Systems

- Service
- Parts
- Accessories
- Products
- Reconditioned Equipment
- Rentals



CRYOFAB



You need it. We supply or make it.



Why Cryofab?

Cryofab, Inc. is the only full-service organization for all makes and models of In-Home Liquid Oxygen Respiratory Systems. We are unique in that we are also a cryogenic equipment manufacturer. By combining our expertise in these fields we offer, by far, the greatest product knowledge and experience in the cryogenic aspect of the Homecare industry.

Founded in 1971, we have weathered the test of time and flourished by keeping up to date on product changes, industry advancements, fabricating and procedural improvements. Maintaining state of the art techniques in welding, super insulation, materials and vacuum technology has been a key factor in our longevity.

Customer service and the ability to deliver parts and service that meet the customer's individual requirements, has enabled us to build an excellent reputation and a company people freely recommend.

- Preventive Maintenance
- Full Service Repairs
- Re-Evacuation Service
- Parts for All Major Manufacturers
- Bulk Tank Distribution Necessities
- Dealer Accessories
- Bulk Distribution Tanks (New and Reconditioned)
- Reconditioned Liquid Base and Portable Systems
- Custom Fabrication
- Trade-In Programs
- Rentals

CRYOFAB, INC. is fully INSURED, FDA REGISTERED and INSPECTED.
1-800-426-2186 • www.cryofabhomecare.com • homecare@cryofab.com

Contents

4, 5	Repair Service
6	Relief Valves
7	Flow Controls
7	Flow Knobs
8	Flowmeters and Flow-Locks
9	Quick Disconnect Valves
10	Economizers
10	Vent-to-Fill Valves
11	Seals
12	Level Gauges
12	Dealer Test/Pressure Gauges
13	Vent Wrenches
13	Assorted Brass and Stainless Steel Fittings
14	Fill Hoses
14	Fill Accessories
15	Posi-Lok Cryogenic Coupling Systems
16	Fill Adapter Caps and Plugs
16	Moisture Pads
17	Miscellaneous Accessories
18	Reconditioned Equipment
19	Rentals
20	Mini-Bulk Station



Repair Service



Properly maintained LOX equipment is the lifeblood of a profitable homecare liquid oxygen provider. Unfortunately, not everyone has the manpower or expertise to accomplish this. Outsourcing becomes the only other alternative. Cryofab, Inc. can custom-fit a repair service to meet your requirements from yearly certifications to major re-building. We will work with you to develop a maintenance program to fit all budgets and requirements.

Authorized
Service and Parts Center
for Pulsair/DeVilbiss/
Sunrise Medical

There are multiple levels to our repair program

Beginning with BASIC SERVICE, containers are filled for NER certification and the set up process for a "Patient Ready Return."

Once a container has liquid in it, a determination is made as to whether a re-evacuation is required. This is accomplished through a weight monitoring procedure on an accurate scale. If the container falls within the original manufacturer specification it moves to completion. If it is out of spec the next level is RE-EVACUATION. The container is placed on a mass spectrometer for a vacuum integrity test. If it passes it proceeds to final evacuation, buffing and Basic Service. Failure of the mass spectrometer test dictates an inner leak, which can only be repaired through a complete re-building of the container. We call this a MAJOR REPAIR. After being re-built the container once again is buffed and finished with a Basic Service. The customer also has the option of sending in a container without the plumbing if they have some diagnostic capability on sight.

The vacuum level in a cryogenic liquid oxygen unit is one of the most important aspects in keeping a system operating properly and efficiently. Without a good vacuum level in your base or portable unit, the performance is severely hampered and can cause unnecessary costs in the way of extra deliveries and service calls.

Not anyone can re-evacuate a cryogenic container and guarantee longevity. It takes not only proper equipment, but time-proven procedures to make sure the vacuum levels on cryogenic dewars last for years. Choosing the RIGHT service provider can be the difference between a vacuum lasting 18 months or multiple years after the fact.

Cryofab, Inc. is a cryogenic container manufacturer with a 32-year history of excellent products, services and reputation. We follow good manufacturing practices, which in turn are used in the service entity of our business. It is our philosophy to be thorough through all aspects of container service, from the time the container arrives to its return to the customer. Testing and evacuation is done with industry standard equipment. FDA guidelines and paperwork are kept and filed for tracking purposes. We offer a one year warranty on vacuum work and 90 days on parts.

All industries continually evolve, especially homecare. Cryofab maintains up to date procedures, training and available educational programs. This enables us to maintain the quality of service and transfer of information that you, the customer, demands.



Our Thorough Repair Procedure:

- Log in (FDA paperwork filled out)
- Inspect for visible defects
- Diagnose (liquid tested for plumbing and vacuum integrity)
- Estimate costs for customer approval
- Repair as per customer instruction
- Re-evacuate if necessary
- Outer buff if requested
- Replace parts
- Re-assemble plumbing
- Liquid test and flow verify for patient-ready set-up
- Complete and file FDA paperwork



Relief Valves



	Manufacturer	Mfg. P/N	Description	Cryofab P/N
1	PB	775138	22 psi x 1/4"NPT (BASE)	RVB22
2	PB	775139	30 psi x 1/4"NPT (BASE)	RVB30
3	PB	775079	22 psi x 1/8"NPT (PORTABLE)	RVP22
4	PB	775082	30 psi x 1/8"NPT (PORTABLE)	RVP30
5	MARK (GREEN)	776828	51 psi x 1/8"NPT (PORTABLE)	CRV-501-AZ-50
6	MARK (BLUE)	775138	22 psi x 1/8"NPT (PORTABLE)	CRV-501-AZ-21
7	MARK (BLACK)	776512	80 psi x 1/8"NPT (PORTABLE)	CRV-501-AZ-80
8	MARK (BASE)	776485	55 psi x 1/4"NPT (PORTABLE)	RVB55
9	CAIRE	10585882	23 psi x 1/4"NPT (BASE)	RVB22
10	CAIRE	10491253	30 psi x 1/8"NPT (PORTABLE)	RVP30
11	PENOX	AZ-3020-AA	22 psi x 1/4"NPT (BASE)	RVP22
12	PENOX	AZ-3021-AA	30 psi x 1/4"NPT (BASE)	RVB30
13	PENOX	BZ-3017-AC	22 psi x 1/8"NPT (PORTABLE)	RVP22
14	PENOX	BZ-3018-AA	30 psi x 1/8"NPT (PORTABLE)	RVP30
15	INDUSTRIAL STYLE 75 psi		75 psi x 1/4"NPT (FILL HOSE)	RVH75
16	INDUSTRIAL STYLE 100 psi		100 psi x 1/4"NPT (FILL HOSE)	RVH100
17	INDUSTRIAL STYLE 150 psi		150 psi x 1/4"NPT (FILL HOSE)	RVH150
18	PULSAIR/DEVILBISS	9022	22 psi x 1/4"NPT (BASE)	9022
19	PULSAIR/DEVILBISS	9020	30 psi x 1/4"NPT (BASE)	9020
20	PULSAIR/DEVILBISS	9021	22 psi x 1/8"NPT (PORTABLE)	9021
21	PULSAIR/DEVILBISS	9023	30 psi x 1/8"NPT (PORTABLE)	9023

Authorized Service and Parts Center
for Pulsair/DeVilbiss/Sunrise Medical.
Complete catalog and price list
available on request.



Flow Controls and Flow Knobs

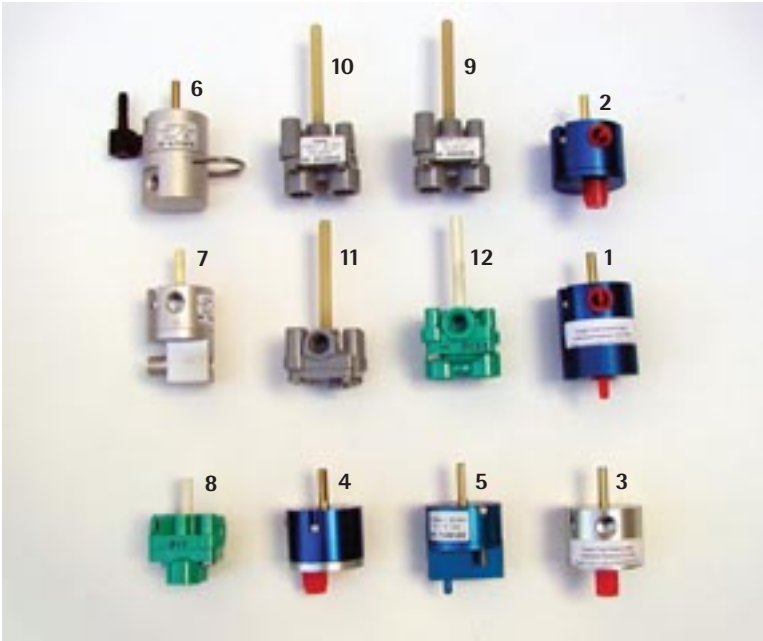

Manufacturer	Mfg. P/N	Description	Cryofab P/N
1 PB	775855	0-6 LPM Comp 41,21,21 Base	CRFCV
2 PB	775859	0-6 LPM C-1000 Portable	C1FCV
3 PB	775889	0-15 LPM Companion High Flow	CTFCV
4 PB	776525	0-6 LPM Mark 5 Portable	M5FCV
5 PB	777918	0-6 LPM Mark 6 Portable	M6FCV
6 CAIRE	10665444	0-6 LPM Gen III Portable	CF322072
7 CAIRE	10480511	0-6 LPM Gen III Base	CF323072
8 PENOX	BZ-3001-DA	0-6 LPM #1,2,3 Portable	36P073
9 PULSAIR	9305	0-6 LPM Travelair 1, Pulsair OMS I and II, Pulsair .5 Portables	9305
10 PULSAIR	9306	0-15 LPM Travelair 1 and DeVilbiss 1 Lt Portable	9306
11 PULSAIR	TA-015	0-6 LPM DeVilbiss .5 and 1 Lt Portable	TA-015
12 PULSAIR	9066	0-2 Low Flow PED Travelair I	9066

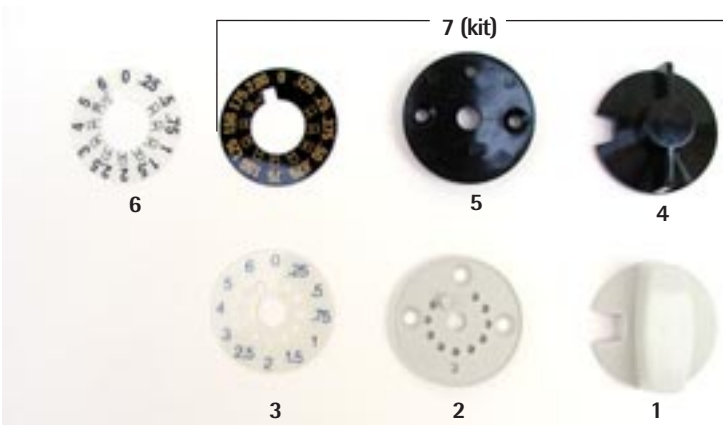

Manufacturer	Mfg. P/N	Description	Cryofab P/N
1 PB	776168	Gray Knob	01CK
2 PB	775877	Gray Plate	02CLP
3 PB	775834	Decal for Gray Knob	03MD
4 PENOX	BF-3191-AA	Black Knob	PXBK
5 PENOX	BZ-3107-AA	Black Plate	PXPB
6 PENOX	AG-3478-AA	Decal	PXD
7 PULSAIR	9307	Knob Kit	9307



Flowmeters and Flow-Locks

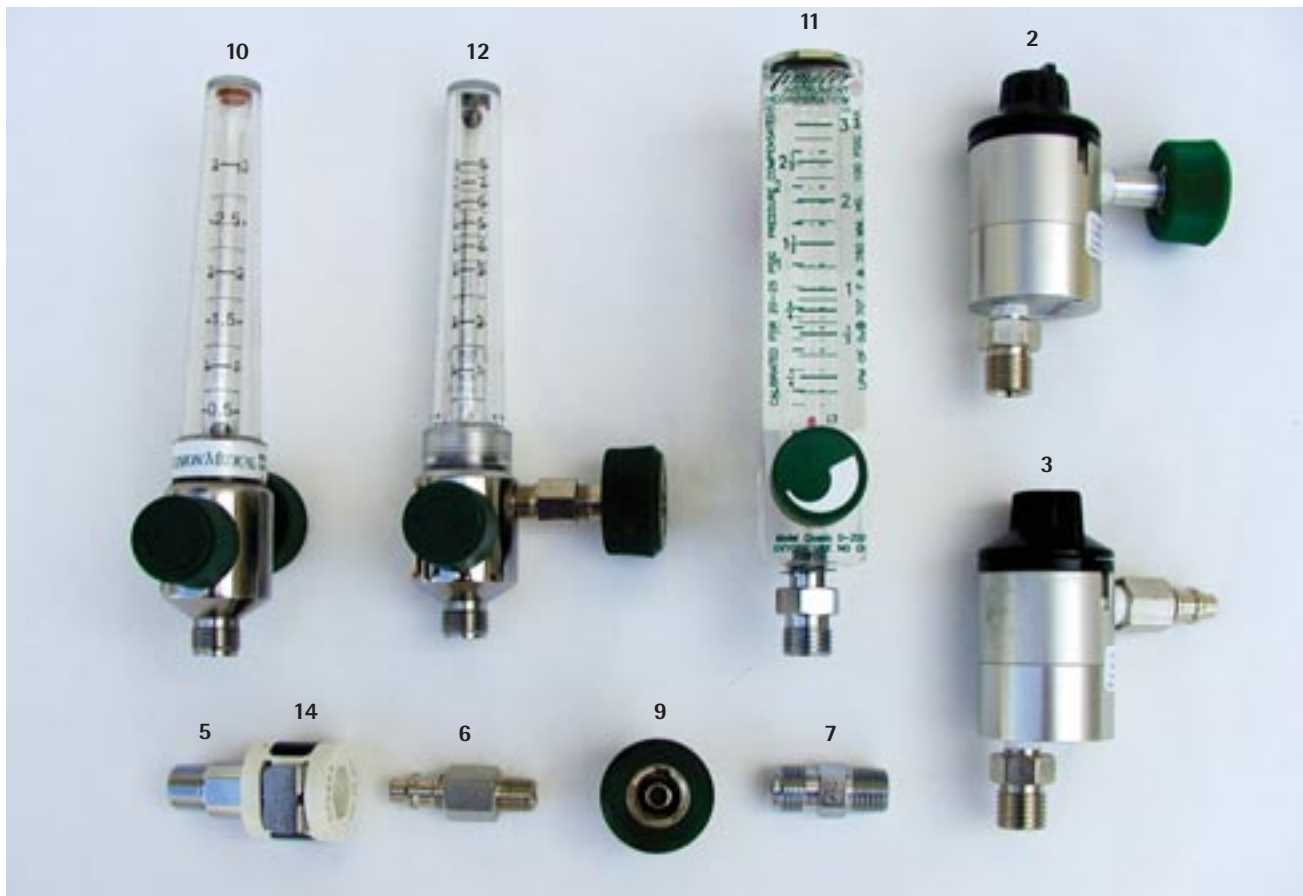

Manufacturer	Mfg. P/N	Description	Cryofab P/N
1 PULSAIR/DEVILBISS	9301-C	*0-6 LPM Flow-Lock, Quick Connect	9301-C
2 PULSAIR/DEVILBISS	9301-D	*0-6 LPM Flow-Lock, DISS	9301-D
3 PULSAIR/DEVILBISS	9302-C	*0-15 LPM Flow-Lock, Quick Connect	9302-C
4 PULSAIR/DEVILBISS	9302-D	*0-15 LPM Flow-Lock, DISS	9302-D
5 PULSAIR/DEVILBISS	9011	Quick Connect	9011
6 PULSAIR/DEVILBISS	9012	Male Quick Connect	9012
7 PULSAIR/DEVILBISS	1094	1/4"NPT Demand Check Valve DISS	1094
8 PULSAIR/DEVILBISS	1115	1/8"NPT Demand Check Valve DISS	1115
9 PULSAIR/DEVILBISS	1095	1/8"NPT Female DISS	1095
10 PULSAIR/DEVILBISS		1/2-3 LPM Flow Meter, DISS	9084-D
11 PULSAIR/DEVILBISS	9080-D	1/8-3 LPM Flow Meter, DISS	9080-D
12 PULSAIR/DEVILBISS	9083-D	0-8 LPM Flow Meter, DISS	9083-D
13 PULSAIR/DEVILBISS	9083-C	0-8 LPM Flow Meter, Quick Connect	9083-C
14 PENOX	AZ-3009-CA	Quick Connect	9011
15 PENOX	AZ-2005-AA	0-8 LPM Flow Meter, Quick Connect	9083-C

* Flow-Lock

Expertly reconditioned
equipment, see page 18.

Quick Disconnect Valves

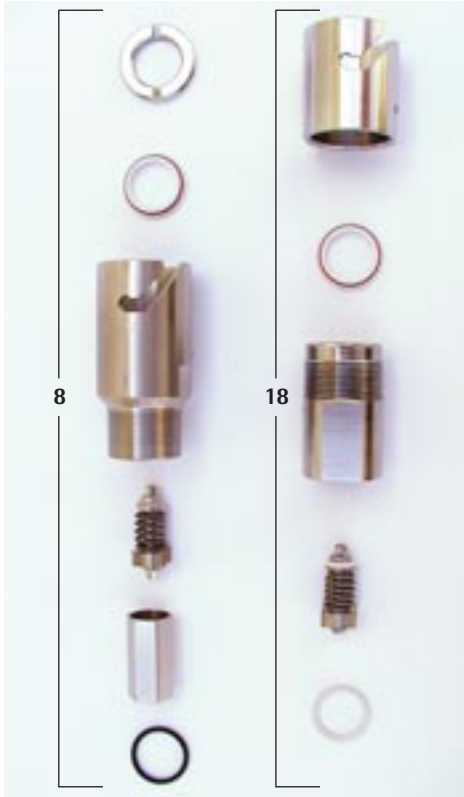

Manufacturer	Mfg. P/N	Description	Cryofab P/N
1 PB	775264	QDV PB Female	PBQDVF
2 PB	775263	Female Adapter	CF9892
3 PB	775322	QDV PB Male	PBQDVM
4 UNION CARBIDE	776806	Male QDV Poppet	MPA
5 UNION CARBIDE	775660	Female Adapter Poppet	UBPA
6 CAIRE	10665364	QDV Gen III Male	CG3M
7 CAIRE	10666439	QDV Gen III Female	CG3F
8 CAIRE	10577858	QVD Gen III Female Ass'y.	CG3FA
9 CAIRE	CA404934	QVD Gen II Male	CG2M
10 CAIRE	CA405321	Caire Sleeve	CG2S
11 CAIRE	CA405321	QDV Gen II Female	CG2F
12 CAIRE	CA405319	Gen II Retaining Ring	CGZRR
13 PENOX	BZ-3024-AA	Penox Body	PXQDVB
14 PENOX	BZ-3025-AA	Penox Sleeve	PXQDVS
15 PENOX	AZ-3023-CA	Penox Male	PXQDVM
16 PULSAIR/DEVILBISS	1092014-001	QVD PB Female	1092014-001
17 PULSAIR/DEVILBISS	1023015-001	QDV PB Male	1023015-001
18 PULSAIR/DEVILBISS	1062014-001	Caire QVD Gen II Female Ass'y.	1062014-001
19 PULSAIR/DEVILBISS	1062010-002	Caire QVD Gen II Male	1062010-002
20 PULSAIR/DEVILBISS	1062011-100	Caire Sleeve	1062011-100
21 PULSAIR/DEVILBISS	1062018-001	Caire QVD Gen II Body	1062018-001
22 PULSAIR/DEVILBISS	1062018-001	Penox Body	1062018-001
23 PULSAIR/DEVILBISS	1062011-101	Penox Sleeve	1062011-101
24 PULSAIR/DEVILBISS	1062010-003	Penox Male	1062010-003
25 PULSAIR/DEVILBISS	1062010-001	Cryo2 Male	1062010-001
26 PULSAIR/DEVILBISS	1062003-100	Cryo2 Sleeve	1062003-100
27 PULSAIR/DEVILBISS	1062018-001	Cryo2 Body	1062018-001

All parts cleaned for oxygen safety.

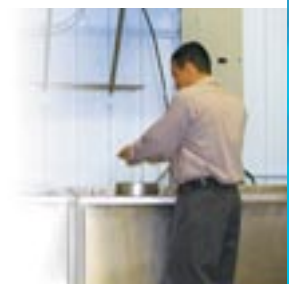



Economizers

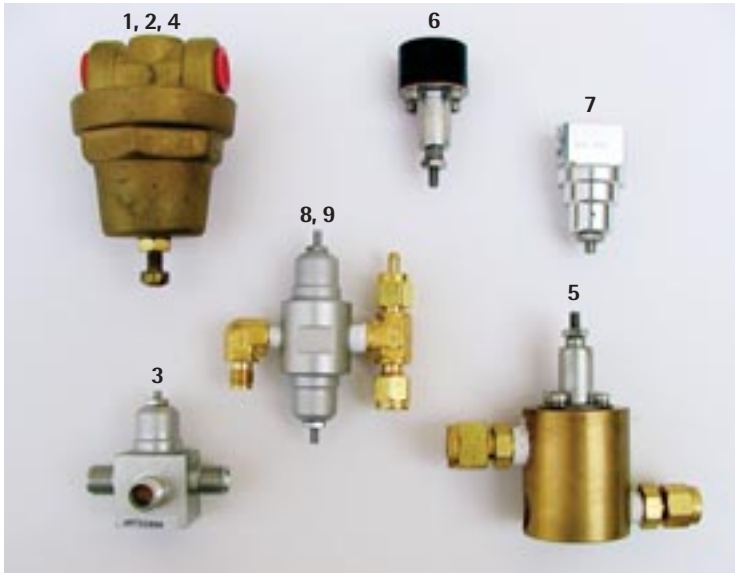

	Manufacturer	Mfg. P/N	Description	Cryofab P/N
1	PB	775149	Base Unit Economizer	ECO/PB 19 PSI
2	CAIRE	10494921	Gen II Base Unit Economizer	ECO/CAIRE 20PSI
3	CAIRE	10531833	Base/Portable Economizer	ECO/CA 20 PSI
4	PENOX	AZ-3022-BA	Base Unit Economizer	ECO/PX 19 PSI
5	PULSAIR/DEVILBISS	1026018-100	Base Unit Economizer	1026018-100
6	PULSAIR/DEVILBISS	1061001-002	Base/Portable Economizer "Old Style"	1061001-002
7	PULSAIR/DEVILBISS	1061001-002	Base/Portable Economizer "New Style"	1061001-002
8	PB	775623	Mark 6 Base RE/VALVE	RE5053
9	PB	701304-00	Mark 6/7 Comp 500/550 RE/VALVE	RE2430

Vent-to-Fill Valves

	Manufacturer	Mfg. P/N	Description	Cryofab P/N
1	PB	775479	Base Unit Vent-to-Fill	PBBVTF
2	CAIRE	10570517	Base Unit Vent-to-Fill	CBVTF
3	PENOX	AZ-3017-AA	Base Unit Vent-to-Fill	PXBVTF
4	PULSAIR/DEVILBISS	1051071-007	Base Unit Vent-to-Fill	1051071-007
5	PENOX	BZ-3044-AA	Portable Unit Vent-to-Fill	PXPVTF
6	PULSAIR/DEVILBISS	1200	Portable Unit Vent-to-Fill	1200
7	PULSAIR/DEVILBISS	1043017-002	Portable Unit Vent-to-Fill	1043017-002

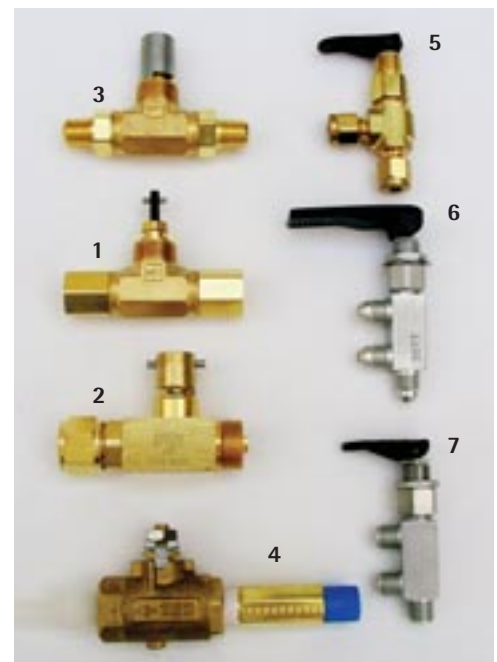

Seals

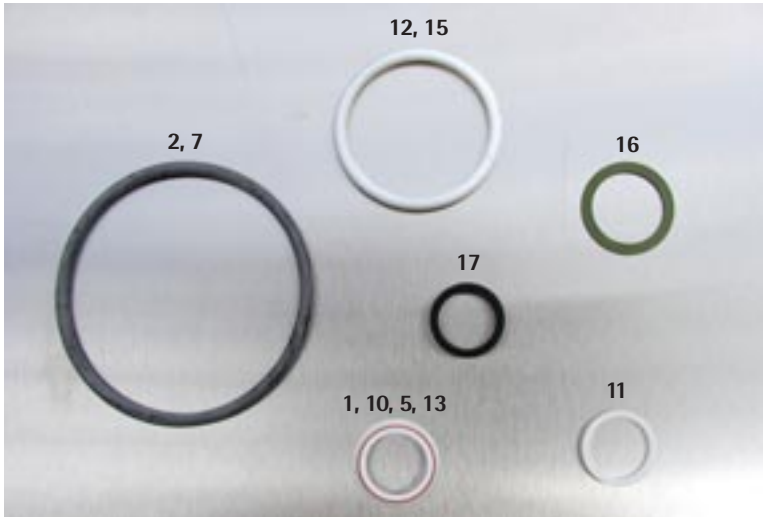

	Manufacturer	Mfg. P/N	Description	Cryofab P/N
1	PB	775260	Lip Seal	CS9129
2	PB	775132	Manifold Seal (Base)	PBMSB
3	PB	775037	Manifold Seal (Port)	PBMSP
4	PB	775262	Female Adapter Seal	CF9893
5	CAIRE	CA110104	Lip Seal	CS9129
6	CAIRE	CA404838	Female QVD O-ring (Base)	CFORB
7	CAIRE	CA405086	Flange Viton O-ring (Base)	CVOR
8	CAIRE	CA404838	Male QVD O-ring (Port)	CMOR
9	CAIRE	10579423	Flange O-ring (Port)	CFORP
10	PENOX	BZ-3011-AA	Lip Seal	CS9129
11	PENOX	BZ-3010-AA	Body Seal Male and Female	CFBSP
12	PENOX	AZ-3007-AA	Flange Seal (Base)	PXM5
13	PULSAIR/DEVILBISS	1062022-001	Lip Seal	CS9129
14	PULSAIR/DEVILBISS	1062024-100	Body Seal Male and Female	CFBSP
15	PULSAIR/DEVILBISS	2009	Flange Seal (Base)	2009
16	UNION CARBIDE/PB	775988	Green Teflon Seal	GPS
17	UNION CARBIDE/PB	775988	Black Lead Seal	BPS

Cryofab, Inc. can custom fit a repair service to your requirements from yearly certifications to major re-building. We work with you to develop a maintenance program to fit budgets and requirements. See page 4.

Send us your tired and troubled masses and we will return to you a clean, efficient operating system.

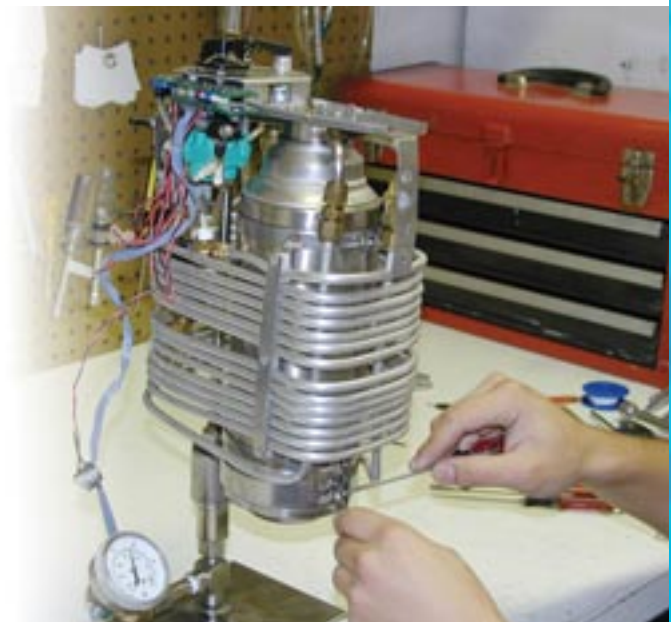



Level Gauges

	Manufacturer	Mfg. P/N	Description
1	PB	775011	Companion Portable
2	PB	775845	Companion 21 Base
3	PB	775846	Companion 31 Base
4	PB	775847	Companion 41 Base
5	CAIRE	10855985	Base and Portable
6	PULSAIR	9008	Grandair/Stationair 40 Lt
7	PULSAIR	9007	Stationair 25 and 30
8	PULSAIR	9259	Weekendair and Stationair 15
9	PENOX	AB-3002-BA	40 Lt Base
10	PENOX	AD-3002-AA	55 Lt Base
11	PENOX	AA-3002-BA	28 Lt Base
12	PENOX	AC-3002-BA	18 Lt Base
13	PENOX	BA-2001-BA	#1 Portable Scale
14	PENOX	BB-2001-BA	#2 Portable Scale
15	PENOX	BC-2001-BA	#3 Portable Scale
16	CAIRE	109857780	1 Lt Portable
17	PULSAIR	109857780	1 Lt Portable
18	PULSAIR	1047110-003	OMS I and Wanderair
19	PULSAIR	1047110-004	OMS II and Travelair
20	PULSAIR	1096017-991	DeVilbiss and Pulsair .5 Lt



Magnehelic® Gauge is a registered trademark of Dwyer Instruments.

Dealer Test/Pressure Gauges



	Manufacturer	Mfg. P/N	Description	Cryofab P/N
1	PB	775258	Dealer Base Unit Test Gauge	1062037-001
2	CAIRE	10679861	Dealer Base Unit Test Gauge (Top)	1062037-001
3	CAIRE	97212021	Dealer Base Unit Test Gauge (Side)	1062031-001
4	PULSAIR/DEVILBISS	1062030-001	Dealer Base Unit Test Gauge	1062030-001
5	PB	775270	Dealer Portable Test Gauge	1062033-001
6	CAIRE	10679871	Dealer Portable Test Gauge (Top))	1062033-001
7	CAIRE	97112026	Dealer Portable Test Gauge (Side)	1062035-001
8	PULSAIR/DEVILBISS	1062034-001	Dealer Portable Test Gauge	1062034-001
9	PENOX	AZ-2015-AA	Dealer Base Unit Pressure Gauge (Q.D.)	1090039-001
10	PULSAIR/DEVILBISS	1090039-001	Dealer Base Unit Pressure Gauge (Q.D.)	1090039-001
11	PULSAIR/DEVILBISS	1090040-001	Dealer Base Unit Pressure Gauge (DISS)	1090040-001
12	CRYOFAB		Replacement Pressure Gauges 0-30 PSI	1090039-030
13	CRYOFAB		Replacement Pressure Gauges 0-60 PSI	1090039-060

Vent Wrenches

	Manufacturer	Mfg. P/N	Description	Cryofab P/N
1	PB	775182	PB Vent Wrench	PBWW
2	UNION CARBIDE	775984	UCC Vent Wrench	UCCVW
3	CAIRE	97202005	Caire Vent Wrench	CVW
4	PENOX	AZ-2016-AA	Penox Vent Wrench	PENVW
5	PULSAIR/DEVILBISS	1051014-002	Pulsair Vent Wrench	GAVKN
6	INVACARE	MLA180	7/16 Nut Driver for VTF	IVK



Assorted Brass and Stainless Steel Fittings



**If you need it,
we'll find it!**

Cryofab stocks more fittings than we can list. Please call us with your requirements at 1-800-426-2186.





Fill Hoses

	Manufacturer	Mfg. P/N	Description	Cryofab P/N
1	PB	775280	6' Fill Hose Without Relief Valve	CFH6SS
2	CAIRE	97406555	6' Fill Hose Without Relief Valve	CFH6SS
3	CRYOFAB		6' Fill Hose Without Relief Valve	CFH6SS
4	PENOX	AZ-2012-AA	6' Fill Hose With Relief Valve	CFH6SSRV
5	CRYOFAB		6' Fill Hose With Relief Valve	CFH6SSRV
6	CRYOFAB		8' Fill Hose Without Relief Valve	CFH8SS
7	CRYOFAB		8' Fill Hose With Relief Valve	CFH8SSRV
8	PB	775281	10' Fill Hose Without Relief Valve	CFH10SS
9	CAIRE		10' Fill Hose Without Relief Valve	10565161
10	CRYOFAB		10' Fill Hose Without Relief Valve	CFH10SS
11	CRYOFAB		10' Fill Hose With Relief Valve	CFH10SSRV
12	CRYOFAB		12' Fill Hose Without Relief Valve	CFH12SS
13	CRYOFAB		12' Fill Hose With Relief Valve	CFH12SSRV
14	PULSAIR	1051818-001	6' Fill Hose Male Flares Both Ends	1051818-001
15	PULSAIR	1051818-002	8' Fill Hose Male Flares Both Ends	1051818-002
16	PULSAIR	1051818-003	10' Fill Hose Male Flares Both Ends	1051818-003



Fill Accessories

	Manufacturer	Mfg. P/N	Description	Cryofab P/N
1	PB	775278	PB Single Fill Adapter	FH6
2	PENOX	AZ-2011-AA	Penox Single Fill Adapter	FH2
3	CAIRE	97212023	Caire Single Fill Adapter	FH1
4	PULSAIR	1051812-003	Pulsair Single Fill Adapter	FH4
5	BUNN		Single Fill Adapter	FH5
6	INSPIRON		Single Fill Adapter	FH3
7	CRYOFAB		Dual Fill Adapter Caire/Penox	DFH12
8	CRYOFAB		Dual Fill Adapter Pulsair/Penox	DFH42
9	CRYOFAB		Dual Fill Adapter PB/Caire	DFH61S
10	CRYOFAB		Dual Fill Adapter Caire/Pulsair	DFH14
11	CRYOFAB		Dual Fill Adapter Caire/Inspiron	DFH13
12	CRYOFAB		Dual Fill Adapter PB/Penox	DFH62S
13	CRYOFAB		Dual Fill Adapter Pulsair/PB	DFH46
14	CRYOFAB		Triple Fill Adapter PB/Pulsair/Caire	TFH641
15	CRYOFAB		Triple Fill Adapter Pulsair/Caire/Penox	TFH412
16	CRYOFAB		Triple Fill Adapter Inspiron/Caire/Pulsair	TFH314
17	CRYOFAB		Triple Fill Adapter Penox/Caire/PB	TFH261
18	CRYOFAB		Triple Fill Adapter Penox/Pulsair/PB	TFH246
19	CRYOFAB		Triple Fill Adapter PB/Inspiron/Penox	TFH632
20	CRYOFAB		Triple Fill Adapter Inspiron/Caire/Penox	TFH312
21	CRYOFAB		Swivel Assembly	S45
22	CRYOFAB		Swivel Assembly Repair Kit	SRK
23	CRYOFAB		5/8 Male Coupling	C58
24	CRYOFAB		In-Line Relief Adapter	1051811-001
25	CRYOFAB		5/8 Female Coupling	FC58
26	CRYOFAB		Bulk Tank Adapter	BA58
27	CRYOFAB		Fill Adapter Repair Kit	SFARK

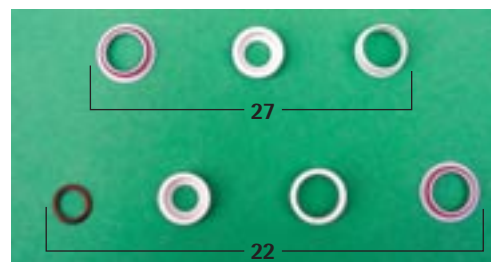

Posi-Lok Cryogenic Coupling Systems

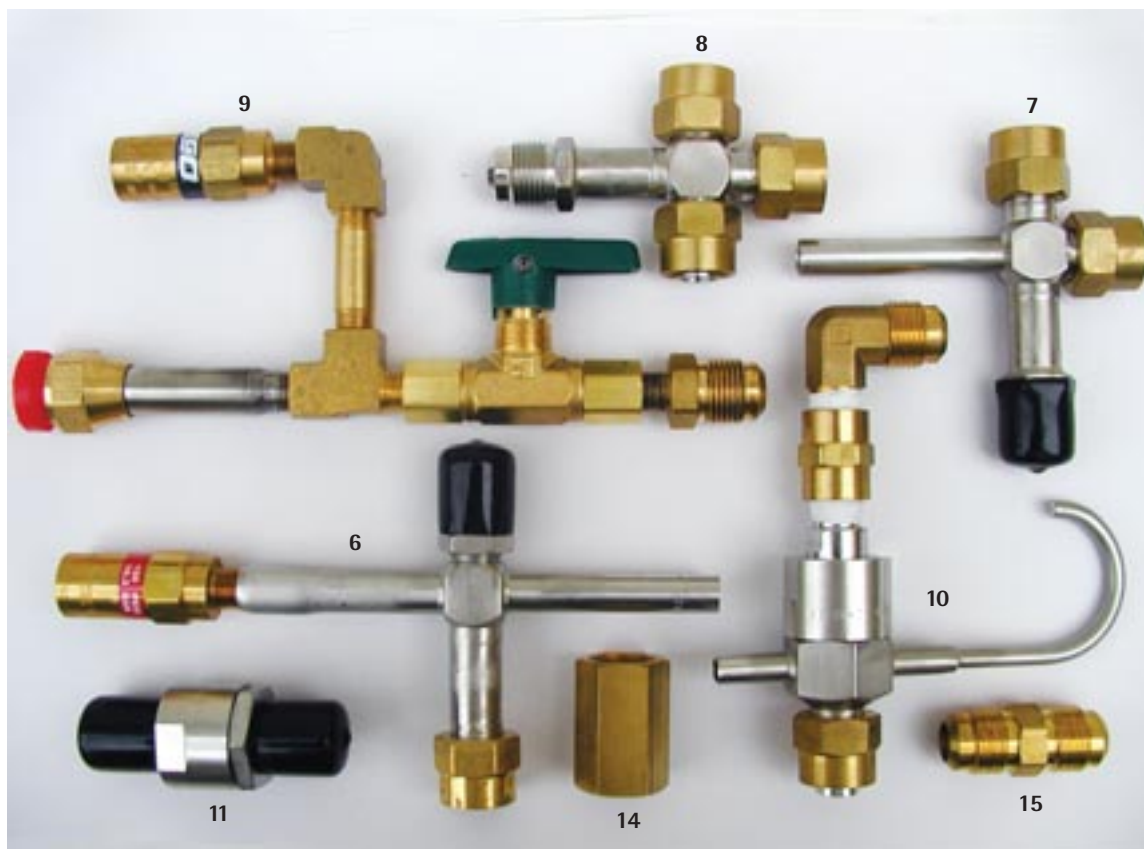

Manufacturer	Description	Cryofab P/N
1	CRYOFAB PB Female Coupler	6PBF
2	CRYOFAB CA/MVE Coupler	1CAMP
3	CRYOFAB Penox Female Coupler	2PXF
4	CRYOFAB Linde/UCC Male Coupler	7LM
5	CRYOFAB Pulsair/Cryo2/DeVilbiss Male Coupler	4PM
6	CRYOFAB Single Fill Adapter With Relief Valve	FHA-1RV
7	CRYOFAB Double Fill Adapter System	FHA-2
8	CRYOFAB Triple Fill Adapter System	FHA-3
9	CRYOFAB Fill Adapter With Shut Off Valve	PCU
10	CRYOFAB Posi-Lok Swivel Fill Assembly	SFHA
11	CRYOFAB Swivel Assembly	S45
12	CRYOFAB Swivel Repair Kit	SRK
13	CRYOFAB Fill Assembly Repair Kit	SFARK
14	CRYOFAB 5/8 Female Coupling	FC58
15	CRYOFAB 5/8 Male Connector	M58
16	CRYOFAB Poppet (Caire/Penox/Pulsair)	CP9289
17	CRYOFAB PB Poppet	CP9971
18	CRYOFAB Posi-Lok Seal	PLS
19	CRYOFAB Lip Seal	CS9129
20	CRYOFAB Penox PB Male Tip Posi-Lok	PXPBPL
21	CRYOFAB Inspiron Male Tip Posi-Lok	INSPPL
22	CRYOFAB Caire Portable Male Tip Posi-Lok	CAPPL
23	CRYOFAB Caire Posi-Lok Hex	CAHEX





Fill Adapter Caps and Plugs



Recommended by the FDA

	Manufacturer	Description	Cryofab P/N
1	Cryofab	Male Plug, Fits Female Type Fillheads	P11961
2	Cryofab	Female Cap, Fits Male Type Fillheads	P12232
3	Cryofab	Male Plug, Aluminum 5/8" Female Hose End	PA001
4	Cryofab	Male Plug, Plastic 5/8" Female Hose End	PP002

Moisture Pads

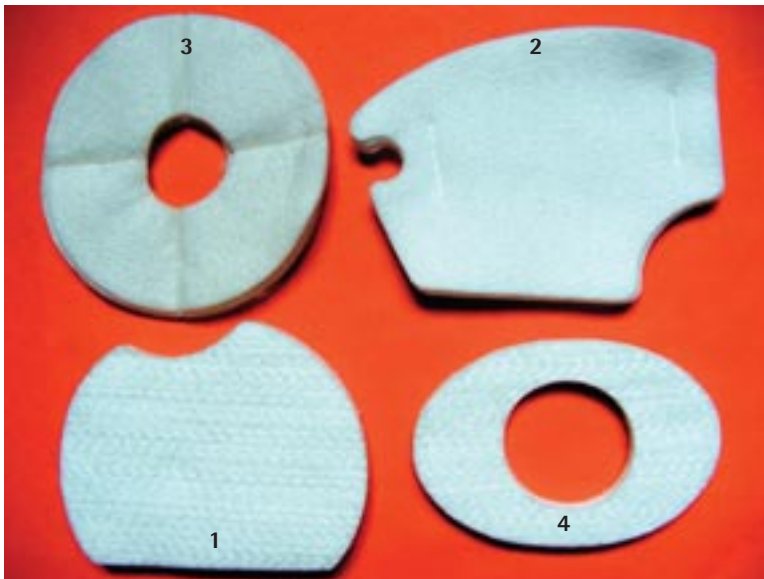

	Manufacturer	Mfg. P/N	Description	Cryofab P/N
1	PB	776869	C1000 Pad	CFN202
2	PB	777904	C500/550 and Mark 6/7 Pad	CFN203
3	Caire	110050	GEN II Pad	CFN201
4	Caire	10542209	GEN III Pad	CFN200

Miscellaneous Accessories

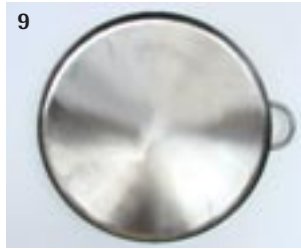

Manufacturer	Mfg. P/N	Description	Cryofab P/N
1 CRYOFAB		Teflon Tape 1/2" Thread Seal	1041A
2 HALOCARBON		Oxygen Compatible Lubricant	9226-A
3 KRYTOX		Oxygen Compatible Lubricant	9285-RD
4 CRYOFAB		Pipe Joint Paste, O2 Safe	LOX 8
5 CRYOFAB		Liquid Leak Detection Fluid	9253-RD
6 CRYOFAB		Pocket Flow Meter	9026
7 CRYOFAB		Bulk Tank Mounting Kit	DSMK
8 CRYOFAB		Bulk Tank Vent Kit	DSVK
9 CRYOFAB		Universal Drip Pan	UDP
10 CAIRE	CA404899	Drain Jar "Flask"	CONDf
11 PENOX/PULSAIR	AZ-2002-BB	Drain Bag	9085
12 PB/PULSAIR	701362	Drain Jar	1025800-100
13 PENOX	AZ-2004-AA	Roller Base	CRB
14 PULSAIR	1051816-001	Roller Base	1051816-001
15 PULSAIR	1030701-001	Roller Base Caster Kit	1030701-001
16 CRYOFAB		Hand Truck	511H1035C5
17 CRYOFAB		Replacement Stair Climber	4042-RB
18 CRYOFAB		Liquid Portable Cart, .5L and 1L	90120
19 PB	775314	Humidifier Adapter SS	PBHD



Lox 8® is a registered trademark of Fluoramics, Inc.; Halocarbon® is a registered trademark of Halocarbon Products Corp.; Krytox® is a registered trademark of Dupont; Snoop® is a registered trademark of Swagelok Co.; Magliner® is a registered trademark of Magline, Inc.



Reconditioned Equipment



Cryofab offers reconditioned equipment as an alternative to purchasing new. This is not to be confused with "used equipment" which has at times a negative stigma. In our process, reconditioned equipment is totally rebuilt to insure longevity in the field and proper function. All units go through a thorough overhaul from vacuum on up to make them operate and appear as close to new as possible. Every aspect of a system, base or portable, is inspected, tested and certified to make sure that all units meet original manufacturer specifications. FDA paperwork is also updated and kept on file for tracking purposes. Call our facility for brand availability.

All equipment comes with a one year warranty on vacuum and 90 days on parts.



Rentals



When owning equipment or purchasing is not an option, Cryofab can offer you rental units, both bases and portables. The same quality and service oriented attitude used in our repair and reconditioning programs is also inherent with our fleet of rental equipment. All units are delivered to you patient ready, fully tested and FDA compliant. This option is as trouble free as possible with Cryofab bearing the responsibility of keeping the units in perfect working order outside of mishandling and tampering occurrences.

The rental fleet consists of Puritan Bennett, Caire, Pulsair and Penox equipment. Please call factory for a particular brand availability. Monthly charges are as follows:

Base Units - \$50.00/month

Portable- \$35.00/month

Complete System- \$85.00/month

Deposit per Unit or System- \$100.00

RENT TO PURCHASE OPTION: Half of all paid rental fees will be applied to the purchase.* Customer must notify Cryofab if they wish to convert to purchase.

Deposit will be held in escrow and returned upon final inspection of returned rental equipment or applied to purchase if that is the avenue chosen.

* up to a maximum of \$500.00 toward a base and \$250.00 toward a portable.



Mini-Bulk Station for Portable Fills



MORE LIQUID CAPACITY
MORE PORTABLE FILLS
MORE CONVENIENCE



The first dedicated MINI-BULK station fabricated solely with Nursing Homes and Hospitals in mind. This container offers more liquid capacity, combined with **PORTABILITY** and a small footprint. It can fill one or more liquid oxygen portable units, any major brand.

Model	CL-80-PF	CL-110-PF	CL-160-PF
Capacity	80 Liters	110 Liters	160 Liters
Outer Diameter	20"	20"	22"
Height	41"	48"	53"
Weight Empty	125 lbs.	178 lbs.	192 lbs.
Weight Full	327 lbs.	455 lbs.	596 lbs.
Static Loss/Day	2 Liters	2 Liters	2.25 Liters
Working Pressure	22 PSIG	22 PSIG	22 PSIG
Liquid Level Gauge	Yes	Yes	Yes

Optional Equipment:

- Self-pressurizing system
- Locking casters
- Larger volumes

All containers are constructed of 304 stainless steel and come standard with an outboard caster configuration.

Oxygen Conversion Data

Quantities	WEIGHT		GAS		LIQUID	
	Pounds (Lb)	Kilograms (Kg)	Cubic Feet (SCF)	Cubic Meters (Nm ³)	Gallons (Gal)	Liters (L)
1 Pound	1.0	0.4536	12.078	0.3173	0.1050	0.3975
1 Kilogram	2.205	1.0	26.632	0.6996	0.2315	0.8762
1 Ton	2000	907.2	24.157	635.0	209.9	794.5
1 SCF Gas	0.08279	0.03755	1.0	0.02629	0.008689	0.03289
1 Nm ³ Gas	3.1491	1.4282	38.04	1.0	0.3305	1.2511
1 Gal Liquid	9.528	4.321	115.1	3.026	1.0	3.785
1 L Liquid	2.517	1.1416	30.41	0.7995	0.2642	1.0

Puritan Bennett Use Time Specifications (Hours)*

Flow Settings (liters/min.)	COMPANION STATIONARY (BASE) UNITS			COMPANION PORTABLE UNITS			
	21	31	41	1000/ℓ	500	550	Helios
.12	620 hrs.	924 hrs.	1241 hrs.	57.1 hrs.	—	—	15 hrs.
.25	620 hrs.	924 hrs.	1241 hrs.	57.1 hrs.	28 hrs.	—	15 hrs.
.5	558 hrs.	832 hrs.	1117 hrs.	21.8 hrs.	18 hrs.	—	10 hrs.
.75	372 hrs.	554 hrs.	744 hrs.	16.7 hrs.	12 hrs.	—	6.5 hrs.
1	279 hrs.	416 hrs.	558 hrs.	13.5 hrs.	9 hrs.	13.5 hrs.	13 hrs.
1.5	186 hrs.	277 hrs.	372 hrs.	9.7 hrs.	6 hrs.	10.5 hrs.	12 hrs.
2	140 hrs.	208 hrs.	279 hrs.	7.6 hrs.	4.6 hrs.	8.5 hrs.	10 hrs.
2.5	112 hrs.	166 hrs.	223 hrs.	6.3 hrs.	3.6 hrs.	7.4 hrs.	8.5 hrs.
3	93 hrs.	139 hrs.	186 hrs.	5.3 hrs.	3 hrs.	6.5 hrs.	6.5 hrs.
3.5	80 hrs.	119 hrs.	160 hrs.	4.6 hrs.	—	—	6 hrs.
4	70 hrs.	104 hrs.	140 hrs.	4.1 hrs.	2.2 hrs.	5.1 hrs.	5 hrs.
5	56 hrs.	83 hrs.	112 hrs.	3.3 hrs.	1.8 hrs.	4.2 hrs.	—
6	47 hrs.	69 hrs.	93 hrs.	2.8 hrs.	1.5 hrs.	3.6 hrs.	—
8	35 hrs.	52 hrs.	70 hrs.	2.1 hrs.	—	—	—
10	28 hrs.	42 hrs.	56 hrs.	1.7 hrs.	—	—	—
15	—	—	—	1.1 hrs.	—	—	—

* Data listed in table is analytical and based on continuous flow without any portable refills.



Caire Liquid Oxygen Use Time Chart

Flow Settings (liters/min.)	STATIONARY (BASE) UNITS: Times are Days-Hours						PORTABLE UNITS: Times are Hours:Minutes		
	L-10	L-20	L-30	L-37	L-45	L-60	Sprint	Stroller	Hi-Flow
Off	16-16	34-17	50-2	61-10	74-19	90-2	30:00	60:00	71:01
.25	16-16	34-17	50-2	61-10	74-19	90-2	20:50	41:40	—
.5	11-12	24-16	35-15	43-18	53-4	66-8	12:55	25:55	32:00
.75	7-15	16-11	23-18	29-3	35-11	45-13	9:25	18:45	—
1	5-17	12-8	17-19	21-20	26-14	34-4	7:20	14:45	16:00
1.5	3-18	8-5	11-21	14-13	17-17	22-18	5:10	10:20	—
2	2-20	6-4	8-21	10-22	13-7	17-1	4:00	8:00	8:00
2.5	2-7	4-22	7-3	8-17	10-15	13-16	3:10	6:25	6:40
3	1-22	4-2	5-22	7-6	8-20	11-9	2:40	5:25	5:33
4	1-10	3-2	4-10	5-11	6-15	6-12	2:05	4:05	4:00
5	1-3	2-11	3-44	4-6	5-7	6-19	1:40	3:20	—
6	0-23	2-1	2-23	3-15	4-10	5-16	1:25	2:45	2:67
8	—	1-12	2-5	2-17	3-7	4-6	—	—	2:00
10	—	1-5	1-18	2-4	2-15	3-10	—	—	1:80
12	—	1-0	1-11	1-19	2-5	2-20	—	—	1:33
15	—	0-19	0-4	1-11	1-18	2-6	—	—	1:07

Note: Times indicated for 20 breaths per minute (BPM) patient. Faster breathing rates will result in shorter use times.

Pulsair Theoretical Oxygen Use Times for Completely Filled Containers

Assuming no liquid is withdrawn for filling portable units and containers have nominal normal evaporation rates (N.E.R.), actual times will vary from unit to unit. This chart is intended to be used only as a guide.

Full contents of 21 psig saturated liquid oxygen: Grandair 93.3#; Stationair 61.5#; Travelair 3.78#; Travelair I 2.53#; Travelair II 4.56#; Wanderair, Wanderair II and Wanderair IID 1.17#; Pulsair I 1.17#; Pulsair II 2.53#.

Flow Rate (LPM-NTP)	STATIONARY (BASE) UNITS				PORTABLE UNITS						
	Grandair* N.E.R. .062#/hr.	Stationair* .053	Travelair .088	Travelair 1* .055	Travelair II* .062	Wanderair .066	Wanderair II* and IID* .055	Pulsair I* .055	Pulsair II* .055	Pulsed Continuous	Pulsed Continuous
1	22.2 days	14.6 days	14.3 hrs.	14.4 hrs.	26.0 hrs.	4.8 hrs.	6.6 hrs.	21.3 hrs.	6.6 hr.	45.4 hrs.	14.4 hrs.
1.5	14.8 days	9.7 days	—	9.6 hrs.	17.3 hrs.	—	4.4 hrs.	15.1 hrs.	4.4 hrs.	32.7 hrs.	9.6 hrs.
2	11.1 days	7.3 days	8.6 hrs.	7.2 hrs.	13.0 hrs.	2.8 hrs.	3.3 hrs.	11.8 hrs.	3.3 hrs.	25.5 hrs.	7.2 hrs.
2.5	8.9 days	5.8 days	—	5.8 hrs.	10.4 hrs.	—	2.6 hrs.	9.7 hrs.	2.6 hrs.	20.9 hrs.	5.8 hrs.
3	7.4 days	4.9 days	6.2 hrs	4.8 hrs.	8.7 hrs.	2.0 hrs.	2.2 hrs.	8.2 hrs.	2.2 hrs.	17.7 hrs.	4.8 hrs.
4	5.5 days	3.7 days	4.8 hrs.	3.6 hrs.	6.5 hrs.	1.5 hrs.	1.7 hrs.	6.3 hrs.	1.7 hrs.	13.6 hrs.	3.6 hrs.
5	4.4 days	2.9 days	3.9 hrs.	2.9 hrs.	5.2 hrs.	1.2 hrs.	1.3 hrs.	5.1 hrs.	1.3 hrs.	11.0 hrs.	2.9 hrs.
6	3.7 days	2.4 days	3.3 hrs.	—	—	—	—	—	—	—	—
8	2.8 days	1.8 days	2.5 hrs.	—	—	—	—	—	—	—	—

* Incorporates economizer valve permitting no evaporation loss with continuous use.

Penox Specifications

	STATIONARY (BASE) UNITS			PORTABLE UNITS			
	Penox Style	Penox Style	Penox Style	Number 1 Universal	Number 2 Universal	Number 2 Univ. Prof. Model	Number 3
Liquid Oxygen	55 liters	40 liters	30 liters	.59 liters	1 liter	1 liter	1.9 Liter
Equivalent Gaseous Liter	47333	34424	25818	508	861	861	1721
Empty Weight	64.8 lbs.	51.6 lbs.	51.5 lbs.	4.16 lbs.	5.3 lbs.	6.4 lbs.	6.86 lbs.
Full Weight	203 lbs.	152.1 lbs.	126.9 lbs.	5.83 lbs.	7.8 lbs.	8.9 lbs.	11.2 lbs.
Duration at 2 LPM	16.25 days	11.75 days	8.75 days	5 hrs.	6.5 hrs.	6.5 hrs.	12.0 hrs.

Authorized Service and Parts Center for Pulsair/DeVilbiss. Complete catalog and price list available on request.



Cryofab, Inc. is the only full-service organization for all makes and models of In-Home Liquid Oxygen Respiratory Systems. We are unique in that we are also a cryogenic equipment manufacturer. By combining our expertise in these fields we offer, by far, the greatest product knowledge and experience in the cryogenic aspect of the Homecare industry.

- Preventive Maintenance
- Full Service Repairs
- Re-Evacuation Service
- Parts for All Major Manufacturers
- Bulk Tank Distribution Necessities
- Dealer Accessories
- Bulk Distribution Tanks (New and Reconditioned)
- Reconditioned Liquid Base and Portable Systems
- Custom Fabrication
- Trade-in Programs
- Rentals

Don't See It?
Call us for our unique custom design and engineering capabilities.



CRYOFAB

Shipping:
540 North Michigan Avenue
Kenilworth, NJ 07033

908-686-3636
FAX: 908-686-9538
1-800-426-2186

Remittance:
P.O. Box 485
Kenilworth, NJ 07033

www.cryofabhomecare.com
homecare@cryofab.com

Products listed and shown herein are registered trademarks of Puritan Bennett, Caire, Penox, Pulsair/DeVilbiss/Sunrise Medical